

Assembly, Use & Closure

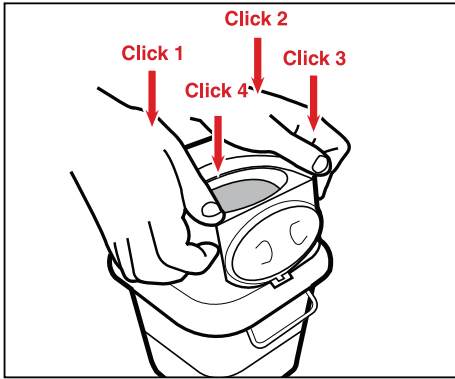

1. Assembly

Place the base of the container on a firm surface, then attach the lid over the base and firmly apply pressure to each corner so that it engages with a “click”.



2. Temporary Close

Ensure temporary closure is engaged when the container is not in use by gently pressing down on the lid until it catches the temporary lock.

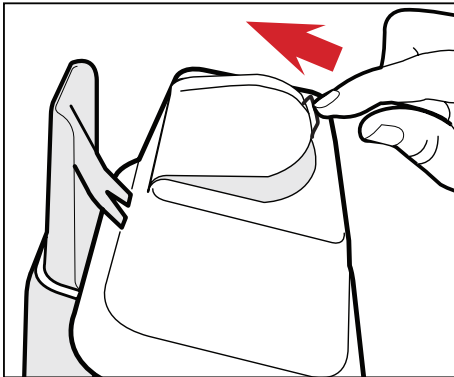

3. Re-open & Use

Push tab up to release lid from temporary closure. Do not fill above the indicated line.

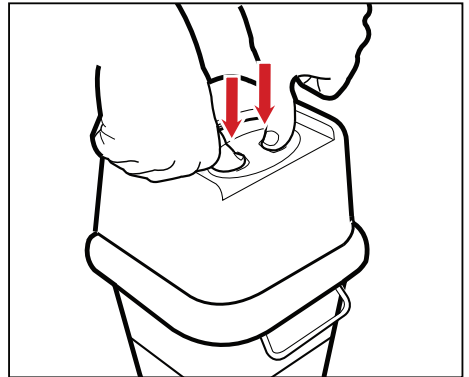

4. Final Closure

Place the container onto solid surface to lock the Sharpsafe container, ensuring the closure tab is fully located in closure recess, ready for disposal.